

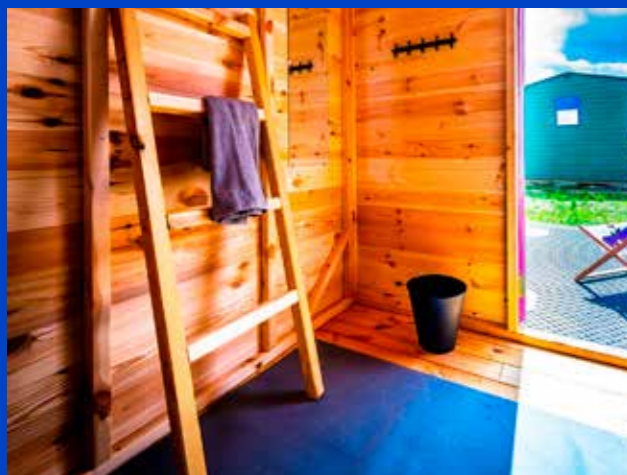

# OPEN'ER SLEEP HUTS



Huts are located about 500m from the main entrance to the festival and 100m from the festival shop.

Each hut is equipped with bed-linen, small chest of drawers, lamp, coat hanger, two deckchairs and extension cord with the ability to charge phones.

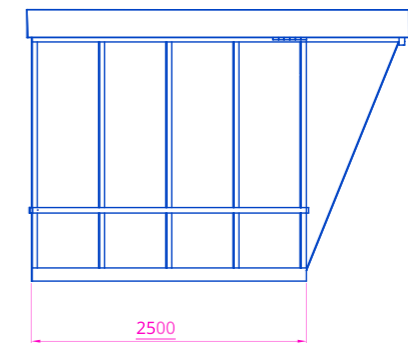
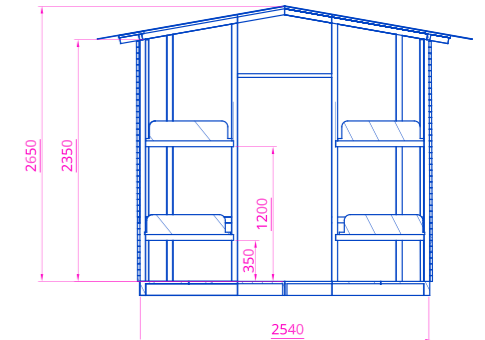

## Sleephuts area includes:

- 🏠 reception
- 🏠 power outlets with ability to connect the hairdryer, electric kettle etc.
- 🏠 separate sanitary zone – shower and toilet containers
- 🏠 roofed area with tables, benches and evening lighting
- 🏠 possibility of ordering cleaning
- 🏠 possibility of renting towels and multi-use cups, plates and cutlery (extra charge)

Each hut will be carefully prepared for your arrival (taking into account the number of people who will rent a hut), so after the purchase please contact us at [sklep@alterart.pl](mailto:sklep@alterart.pl) and indicate the appropriate configuration:

- 🏠 1-person hut (single bed)
- 🏠 2-person hut (two single beds or one double bed)
- 🏠 3-person hut (one bunk bed and one single bed)
- 🏠 4-person hut (two bunk-beds)

Maximum number of people that can be accommodated in a hut is 4 (only for bearers of 1-day tickets, 2-day weekend tickets or 4-day tickets with "Sleephuts" wristband)

The fee for renting a hut, regardless of the number of days spent in it, is fixed.

When buying a ticket (payment by cash transfer or with cash at check-in), a damage deposit in the amount of 1000PLN will be charged. Full or partial refund will be made in the same form of payment originally used for purchase.